

Glendive Wind, LLC

June 23, 2025

VIA UPS NEXT DAY AIR

Prairie County, Montana Road Department
Attn: Todd Henry, Foreman
PO Box 568
Terry, MT 59349

Re: Petition for Permit for Approach

Dear Mr. Henry:

Enclosed with this letter, you will find a copy of the draft Road Use Agreement that was previously submitted to the County Commissioners for their consideration. We appreciate the County's effort in reviewing and commenting on Glendive Wind's proposed Road Use Agreement. We are hopeful that this Road Use Agreement can serve as a starting point for moving forward with the project.

As a next step in the process, Glendive Wind hereby submits its Petition for Permit for Approach to your department. This application should help advance the necessary approvals and move the project forward in a coordinated manner. To support your evaluation of the permit application and the accompanying Road Use Agreement, we have also included a preliminary route map and a preliminary load analysis. These materials are intended to provide clarity on the proposed use of the road system, including the expected transportation routes, vehicle types, and anticipated loads. We believe this additional information will be helpful in assessing the scope of road impacts and in guiding any further discussion about road maintenance, safety considerations, and mitigation measures. For the avoidance of doubt, the application only requests the County's approval as it pertains to county rights-of-way, and any necessary approvals from adjacent property owners or the Montana Department of Transportation will be sought separately.

Also, as you may know, Glendive Wind has previously submitted a proposed Development Agreement to the County on December 30, 2024. While not necessary to allow the project to move forward, the Development Agreement is an option for capturing some of the terms between Glendive Wind and the County. We are happy to discuss the best process at any time.

Glendive Wind, LLC

700 Universe Boulevard, Juno Beach, FL 33408

Re: Petition for Permit for Approach

Our goal is to work collaboratively with your department to reach agreement on the Road Use Agreement and the related permit in a way that meets the County's standards while also addressing the logistical needs of the project. We believe the proposed approach represents a fair and constructive path forward—balancing the County's interest in protecting public infrastructure with the practical requirements of project access.

We sincerely appreciate your time and attention to this matter, and we welcome the opportunity to engage in further discussion. Please do not hesitate to contact us with any questions, feedback, or requests for additional information. We look forward to working together to achieve a successful and well-coordinated outcome. I can be reached directly at (561) 608-4030 or by email at Ross.Feehan@NextEraEnergy.com.

Sincerely,



Ross Feehan
NextEra Energy Resources
Telephone: (561) 608-4030
Email: ross.feehan@nexteraenergy.com

Enclosures

Road Use Agreement (Draft)
Petition for Permit for Approach
Preliminary Route Map
Preliminary Load Analysis

Copy to:

County Commission, Prairie County, Montana

Approach	Road	Length of Excavation	Plain Language Description	Location	Section	Township	Range	Latitude	Longitude
1	Intersection of South Fork Clear Creek Road and North Bad Route Road	Approximately 150 feet	Northeast corner of intersection	Qtr. Qtr.	3 T16N		R50E	47.166285°	-105.368177°
2	South Fork Clear Creek Road	Approximately 150 feet	Northeast side of road (at turn from N/S to E/W)	Southwest	11 T16N		R50E	47.151912°	-105.368678°
3	Intersection of South Fork Clear Creek Road and Road 209	Approximately 150 feet	Northwest corner of intersection	Southwest	12 T16N		R50E	47.151950°	-105.325941°
4	Intersection of W Bad Route Road and Bad Route Road	Approximately 150 feet	Southwest corner of intersection	Northeast	13 T16N		R50E	47.150581°	-105.325614°
5	Intersection of W Bad Route Road and Chester Lane Road	Approximately 150 feet	Southwest corner of intersection	Northeast	21 T15N		R50E	47.092767°	-105.346618°
6	Intersection of Bad Route Road and North Bad Route Road	Approximately 150 feet	Northwest corner of intersection	Southwest	34 T16N		R50E	47.093849°	-105.368021°
7	Intersection of Bad Route Road and Private Road	Approximately 150 feet	Northwest corner of intersection	Southwest	24 T16N		R49E	47.122874°	-105.453600°
8	Intersection of Bad Route Road and Brackel Creek Road	Approximately 150 feet	Northwest corner of intersection	Southwest	21 T16N		R49E	47.122777°	-105.517100°
9	Intersection of Bad Route Road and Prairie Road	Approximately 150 feet	Southwest corner of intersection	Southwest	19 T16N		R49E	47.121721°	-105.517088°
10	Intersection of Bad Route Road and Cedar Creek Road	Approximately 150 feet	West corner of intersection	Southwest	19 T16N		R49E	47.122592°	-105.559487°
11	Intersection of Bad Route Road, Cedar Creek Road and Xit Road	Approximately 150 feet	East side of road (at turn from N/S to NE/SW)	Northeast	36 T16N		R48E	47.104572°	-105.580584°
12	Xit Road	Approximately 150 feet	East side of road (at turn from N/S to NE/SW)	Northeast	21 T15N		R48E	47.093141°	-105.606365°
13	Xit Road	Approximately 150 feet	East and west side of road (at turn from NE/SW to NW/SE)	Southwest	21 T15N		R48E	47.082983°	-105.803186°
14	Xit Road	Approximately 150 feet	West side of road (at turn from NW/SE to NE/SW)	Northeast	11 T15N		R48E	47.078879°	-105.609688°
15	Intersection of Highway 253 and Xit Road	Approximately 150 feet	Southwest corner of intersection	Southwest	25 T15N		R48E	47.031028°	-105.598360°
16	Intersection of West Bad Route Road and Bad Route Road	Approximately 150 feet	Northwest corner of intersection	Southwest	21 T15N		R50E	47.064897°	-105.346729°
17	North Bad Route Road	Approximately 150 feet	Southwest side of road (at turn from N/S to E/W)	Southwest	7 T16N		R50E	47.165267°	-105.451897°
18	Prairie Road	Approximately 150 feet	Southeast side of road (at turn from N/S to E/W)	Northwest	5 T16N		R49E	47.160605°	-105.557472°

PETITION FOR PERMIT FOR APPROACH

The undersigned, on behalf of Glendive Wind, LLC, hereby petitions the Board of Prairie County Commissioners to cross Prairie County property described as follows:

See attached Exhibit A

for the following purpose:

Glendive Wind, LLC is developing the Glendive Wind energy project, which will use wind turbines to generate energy. Due to their length, the trucks transporting turbine blades to the turbine sites need wider intersections at certain county road intersections in order to turn safely and effectively.

Composition of Road: Gravel

Length of Excavation: See attached Exhibit A

Amount of Deposit Required: \$2,700.00

DATED this 23 day of June, 2025.

Glendive Wind, LLC

By: Ross Feehan, its authorized agent

We, the Board of County Commissioners hereby approve/disapprove (circle one) the above request this _____ day of _____, _____.

Chairman

Member

Member

~~Nextera~~ Nextera Version

ROAD USE AND MAINTENANCE AGREEMENT

THIS ROAD USE AND MAINTENANCE AGREEMENT ("**Agreement**") is entered into as of this ____ day of _____, 2025 ("**Effective Date**") by and between the _____ County, whose address for purposes of this Agreement is _____ ("**County**") and Glendive Wind, LLC, a Delaware limited liability company, whose address for purposes of this Agreement is 700 Universe Boulevard, Juno Beach, Florida 33408 ("**Glendive Wind**" and, with County, the "**Parties**").

RECITALS

WHEREAS, Glendive Wind is developing a commercial wind turbine electrical generation facility commonly referred to as the Glendive Wind Project ("**Project**") on a site located in Prairie, Dawson, McCone, Garfield, and Rosebud Counties, Montana, with an expected total nameplate capacity of approximately 800 megawatts ("**MW**"); and

WHEREAS, Glendive Wind intends to obtain the necessary approvals to build, operate and maintain the Project; and

WHEREAS, in connection with the construction, operation and maintenance of the Project, the Parties desire to address certain issues relating to the roads owned, operated and maintained by the County (collectively, the "**Roads**") over which it will be necessary for Glendive Wind and Glendive Wind's Representative(s) to, among other things: (i) transport heavy equipment and materials which may be in excess of local design limits of certain Roads, (ii) transport locally sourced materials, such as concrete and gravel, on the Roads; (iii) make specific modifications and improvements (both temporary and permanent) to the Roads (including various associated culverts, bridges, road shoulders and other fixtures) to permit such equipment and materials to pass; and (iv) place overhead and underground electrical and communication cables (collectively "**Cables**") for the Project adjacent to, along, under or across such Roads; and

WHEREAS, Glendive Wind and the County wish to set forth their understanding and agreement relating to the use of Roads during the construction and operation of the Project; and

NOW, THEREFORE, in consideration of the mutual terms and conditions set forth in this Agreement, and for other good and valuable consideration, receipt of which is hereby acknowledged, the Parties agree as follows:

TERMS AND CONDITIONS

1. Glendive Wind will undertake the following activities in accordance with the terms of this Agreement:

a. Designate a company representative with authority to represent Glendive Wind. As of the date of the Agreement, the company representative is Ross Feehan, with a telephone number of (561) 608-4030 and an email of ross.feehan@nexteraenergy.com.

b. At least sixty (60) days prior to beginning construction of the Project, provide the County with a preliminary site plan identifying turbine locations, site access points, and road crossings, to be attached as **Exhibit A**, along with the preliminary transportation route for the Project equipment attached as **Exhibit B**, subject to amendment;

c. Provide plans to the County for the widening of any corner radius necessary to facilitate the turning movements of the transport trucks used by Glendive Wind during construction of the Project; make any necessary improvements; and at the conclusion of construction, remove any such improvements as the County directs and restore the affected property to its original condition;

d. Erect permanent markers indicating the presence of the Cables and install tape in any trench in which Glendive Wind has placed or will place Cables in a County right-of-way. All Cables shall be buried at a minimum depth of forty-eight (48) inches below the road surface;

e. Notify the County Highway Superintendent in advance of all oversize transportation and crane crossings over, across or along any Road;

f. Transport or cause to be transported the tower segments and other oversize loads in a reasonable effort to minimize adverse impact on the local traffic;

g. Provide reasonable advance notice to the County when it is necessary for a Road to be closed due to a crane crossing or for any other reason relating to the construction of the Project. Notwithstanding the foregoing, Glendive Wind will provide no less than twenty-four (24) hours notice when reasonably practicable and will provide all materials necessary to close the Road;

h. Provide signage of all road closures and work zones in compliance with the Manual on Uniform Traffic Control Devices and as may be required by the County;

i. Purchase and deliver applicable road materials for repairs to Roads that are damaged by Glendive Wind and/or a Glendive Wind Representative during the hauling of materials and/or construction of the Project and bear the reasonable costs to restore any Roads that are damaged by Glendive Wind and/or an Glendive Wind Representative during the hauling of materials and/or construction of the Project to the condition enjoyed immediately prior to such damage occurring, to the extent reasonably possible;

j. Cables may cross a road, in which case, these Cables will be bored under the road, buried at a minimum depth of forty-eight (48) inches below the road surface and the crossing shall be restored promptly to its pre-construction condition;

2. The County, in accordance with the terms of this Agreement, agrees that it shall:

a. Within fifteen (15) days following the Effective Date of this Agreement, designate a County representative with authority to represent the County. As of the date of the Agreement, the County representative is _____, with a telephone number of (406) _____ and an email of _____.

b. Timely perform routine and regular maintenance of the Roads including: grading, snow removal, striping, routine signage, and regularly scheduled maintenance and repair;

c. Timely review and approve all Project-related access points and road crossings, which are submitted by Glendive Wind in **Exhibit A and B**;

d. Timely review and approve plans for all Project-related utility encroachments on County rights-of way; which are submitted by Glendive Wind in accordance with **Exhibit A and B**;

e. Authorize the designated County representative to agree on behalf of County to revisions to **Exhibit A and B** and the final location of Road crossings, access points, and utility encroachments as revisions are submitted to the County by or on behalf of Glendive Wind.

3. Planning Inventory

a. Road Inventory

1. Pre-Construction Inventory. At least sixty (60) days prior to beginning construction of the Project, the Parties shall jointly perform a survey to record the condition of the pavement surface of the Roads which will be used in the transport of equipment to the Project. During this survey, the entire length of the roads shall be videotaped and if deemed necessary by the parties, photographs may also be taken. In addition, the County will provide Glendive Wind, if available, with copies of any plans, cross-sections and specifications relevant to the existing Roads structure. Copies of all pre-construction documentation shall be provided to each of the Parties. Glendive Wind will reimburse the County for all costs associated with the Pre-Construction Inventory.

2. Post-Construction Inventory

i. Upon completion of construction of each phase of the Project, representatives of the County and Glendive Wind will perform a post-construction inventory, the methods of which shall be similar to those of the Pre-Construction Inventory described above. The two sets of pre and post-construction data will be compared and if there is any wheel lane rutting, cracking or other damage in excess of the original survey, the County and Glendive Wind will determine the extent of the repairs or improvements needed to return the roads to a pre-construction condition. All costs associated with the Post-Construction Inventory shall be borne solely by Glendive Wind.

ii. Glendive Wind shall be obligated to make any or all repairs necessary to return the roads to a pre-construction condition, at its sole cost and expense. Within ten (10) calendar days following the completion of the Post-Construction Inventory, Glendive Wind shall provide notice to the County identifying those repairs which Glendive Wind agrees to undertake and the expected date by which such repairs shall be completed.

b. Routing and Access Approval. As soon as practical after execution of this Agreement and as necessary throughout the construction of the Project, Glendive Wind and County shall meet to discuss routing for the transportation of equipment to the Project, Project-related access points, road crossings and Cable locations and the County shall review and approve the same in accordance with Sections 2.

4. Mutual Indemnification/Hold Harmless and Liability Insurance Provisions.

a. Indemnity. Each Party (the “**Indemnifying Party**”) agrees to indemnify, defend and hold harmless the other Party and such other Party’s mortgagees, lenders, officers, employees and agents (the “**Indemnified Party**”) against any and all losses, direct or indirect damages (including consequential damages), claims, expenses, and other liabilities, including, without limitation, attorneys’ fees, resulting from or arising out of (i) any negligent act or negligent failure to act on the part of the Indemnifying Party or anyone else engaged in doing work for the Indemnifying Party, or (ii) any breach of this Agreement by the Indemnifying Party. This indemnification shall not apply to losses, damages, claims, expenses and other liabilities to the extent caused by any negligent or willful act or omission on the part of the Indemnified Party.

b. Limitations of Liability. In no event shall Glendive Wind or any of its members, officers, directors or employees or the County or any of its Boards, officers or employees be liable (in contract or in tort, involving negligence, strict liability, or otherwise) to any other Party or their contractors, suppliers, employees, members and shareholders for indirect, incidental, consequential or punitive damages resulting from the performance, non-performance or delay in performance under this Agreement.

c. Required Insurance. Glendive Wind shall upon commencement of construction of the Project and for the period of construction of the Project, maintain in full force and effect commercial general liability insurance, in the aggregate amount equal to Three Million Dollars (\$3,000,000). Glendive Wind may utilize any combination of primary and/or excess insurance to satisfy this requirement and may satisfy this requirement under existing insurance policies for the Project.

5. Miscellaneous

a. Remedies and Enforcement. The Parties acknowledge that money damages would not be an adequate remedy for any breach or threatened breach of this Agreement. Each of the parties hereto covenant and agree that in the event of default of any of the terms, provisions or conditions of this Agreement by any Party (the “**Defaulting Party**”), which default is not caused by the Party seeking to enforce said provisions (the “**Non-Defaulting Party**”) and after notice and reasonable opportunity to cure has been provided to the Defaulting Party, then in such an event, the Non-Defaulting Party shall have the right to seek specific performance and/or injunctive relief to remedy or prevent any breach or threatened breach of this Agreement. The remedies of specific performance and/or injunctive relief shall be exclusive of any other remedy available at law or in equity.

b. Due Authorization. Glendive Wind hereby represents and warrants that this Agreement has been duly authorized, executed and delivered on behalf of Glendive Wind. The County hereby represents, and warrants that this Agreement has been duly authorized, executed and delivered on behalf of the County.

c. Severability. If any provision of this Agreement proves to be illegal, invalid, or unenforceable, the remainder of this Agreement will not be affected by such finding, and in lieu of each provision of this Agreement that is illegal, invalid, or unenforceable a provision shall be deemed added as may be possible to accurately reflect the intentions of the Parties and so as to make the unenforceable provision legal, valid, and enforceable.

d. Amendments. This Agreement constitutes the entire agreement and understanding of the parties and supersedes all offers, negotiations and other agreements. There are no representations or understandings of any kind not set forth herein. No amendment or modification to this Agreement or waiver of a Party's rights hereunder shall be binding unless it shall be in writing and signed by both Parties to this Agreement.

e. Notices. All notices shall be in writing and sent (including via email or facsimile transmission) to the Parties hereto at the addresses set forth in the Preamble (or to such other address as either such Party shall designate in writing to the other Party at any time).

f. Counterparts. This Agreement may be executed in any number of counterparts, each of which shall be deemed an original, with the same effect as if the signatures thereto and hereto were upon the instrument. Delivery of an executed counterpart of a signature page to this Agreement by email or facsimile shall be as effective as delivery of an originally signed counterpart to this Agreement.

g. Governing Law. This Agreement shall be governed by and interpreted in accordance with the laws of the State of Montana, irrespective of any conflict of laws provisions. Both parties desire that the transactions contemplated hereby be effected and carried out in a manner that is in compliance with all laws.

h. Successor and Assigns. This Agreement shall inure to the benefit of and shall be binding upon the Parties hereto, their respective successors, permitted assignees, and legal representatives. This Agreement may not be assigned without the written consent of the Parties, which consent shall not be unreasonably withheld. Notwithstanding the foregoing, Glendive Wind may assign this Agreement to its affiliates and may collaterally assign this Agreement to any lender in support of the Project.

i. Waiver. If either Party waives any term or provision of this Agreement at any time, that waiver will be effective only for the specific instance and specific purpose for which the waiver was given. If either Party fails to exercise or delays exercising any of its rights or remedies under this Agreement, then that Party retains the right to enforce that term or provision at a later time.

j. Further Assurances. Whenever in this Agreement the approval or consent of either County or Glendive Wind is required or contemplated, unless otherwise specifically stated, such approval or consent shall not be made the subject of a demand for additional compensation, nor otherwise unreasonably conditioned, withheld or delayed.

k. Waiver of Jury Trial. In any litigation arising from or related to this Agreement, the parties hereto each hereby knowingly, voluntarily and intentionally waive the right each may have to a trial by jury with respect to any litigation based hereon, or arising out of, under or in connection with this Agreement.

[signature page follows]

IN WITNESS WHEREOF, the Parties have caused this Agreement to be executed in their respective names by their duly authorized officers.

Glendive Wind:

Glendive Wind, LLC
a Delaware limited liability company

By: _____
Name: _____
Title: _____

Approved as to Form:

By: _____
Name: _____
Title: Counsel for Glendive Wind, LLC

County:

_____ County, Montana

By: _____
Name: _____
Title: _____

ATTEST:

By: _____
Name: _____
Title: County Clerk

Approved as to Form:

By: _____
Name: _____
Title: County Attorney

EXHIBIT A

Preliminary Site Plan



EXHIBIT B

Preliminary Transportation Route

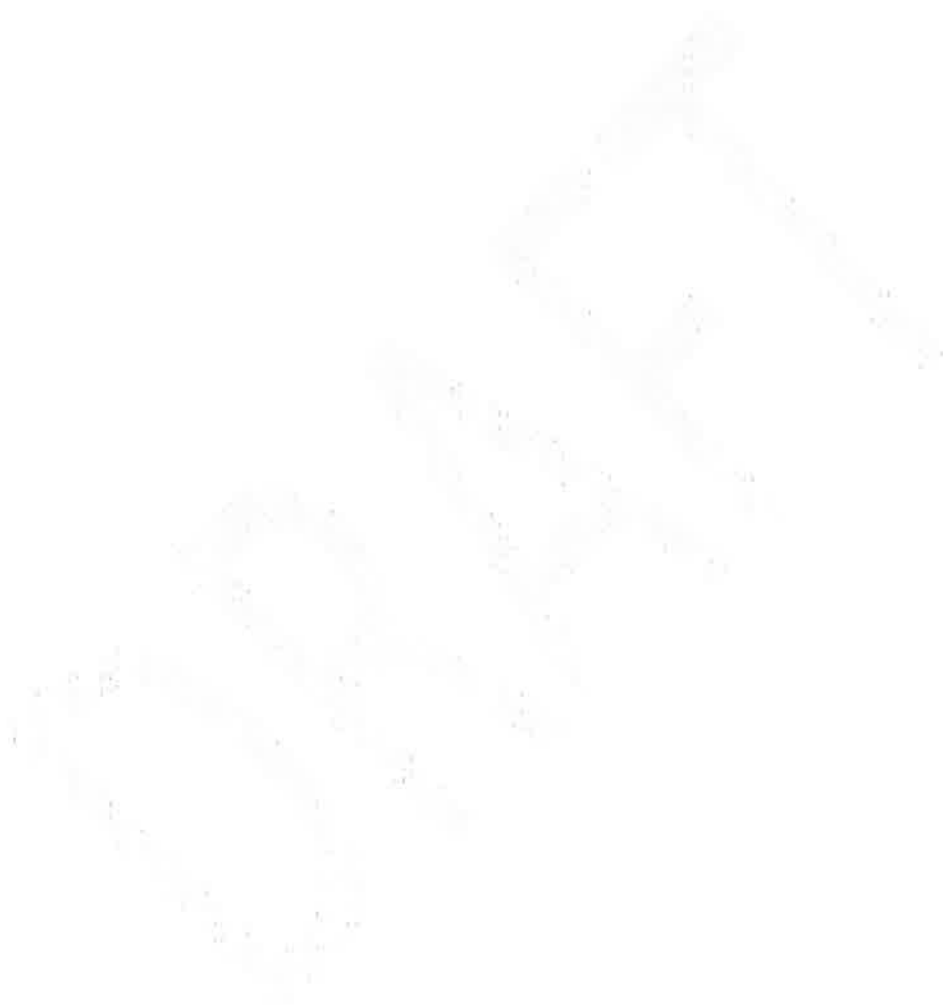

MEMORANDUM

Date: May 27, 2025

Re: Preliminary Construction Traffic Estimates for the Glendive Wind Project

To: Ross Feehan,
NextEra Energy Resources
Senior Project Manager – Development

From: Westwood Professional Services

NextEra Energy Resources (NextEra) is developing the Glendive Wind project located within Prairie, Dawson and McCone Counties in Montana. NextEra contracted Westwood Professional Services (Westwood) to estimate the construction-related truck counts, and the associated Equivalent Single Axle Load (ESAL) values, which are anticipated on local roads. This memo provides an overview and summary of this analysis.

Equivalent Single Axle Loads (ESALs) are a measurement used by pavement engineers to represent traffic impacts on pavement. ESAL calculations consider factors such as axle configuration, total weight, and traffic volume to provide a standardized measure of pavement wear and tear. One ESAL is defined as the damage caused by a single axle load of 18,000-pounds.

Methodology:

Westwood performed the following general steps:

1. Analyze the preliminary project layouts to estimate the material/equipment required to construct the project, and the resulting number of construction-related truck loads.
2. Analyze the existing public road network and identify public road segments anticipated to be used for project truck traffic. Approximately 110 miles of public roads were evaluated across multiple counties.
3. Model the estimated truck traffic on the existing public road network, resulting in an estimated number of trucks for each segment of public road.
4. Calculate the ESALs on each road segment using established Load Equivalency Factors (LEFs) and various engineering assumptions.

MEMORANDUM

Results:

Glendive Wind Project

1. Estimated ESALs are divided primarily between two project entrance locations
 - a) From the east off State Highway 200S using road FAS 467 - approximately 68,000 ESALs
 - b) From the west from Highway 235N - approximately 125,000 ESALs.
2. ESAL estimates include the construction of 204 primary turbine locations, 3 substation locations, O&M facility, batch plant, 3 laydown yards, approximately 102 miles of proposed access roads, various intersection improvements, and public road improvements (assumed 2" gravel overlay depth on public roads).
3. Refer to Attachment E for a map with anticipated ESALs.
4. Refer to Attachment F for a table of truck counts and ESALs by road segment.

Summary:

Westwood Professional Services has estimated the construction-related truck counts, and the associated Equivalent Single Axle Load (ESAL) values anticipated on local roads resulting from the project. This information can be used for discussion with local authorities to support project permitting, and in various future analyses to support the design/construction of this project.

Attachments:

E. Glendive Wind ESAL Map (*Glendive Wind ESAL.pdf*)

F. Glendive Wind Truck Count and ESAL Table (*Glendive Wind ESAL – Export.xlsx*)

ATTACHMENT E

© 2023 Westwood Engineering Services, Inc.

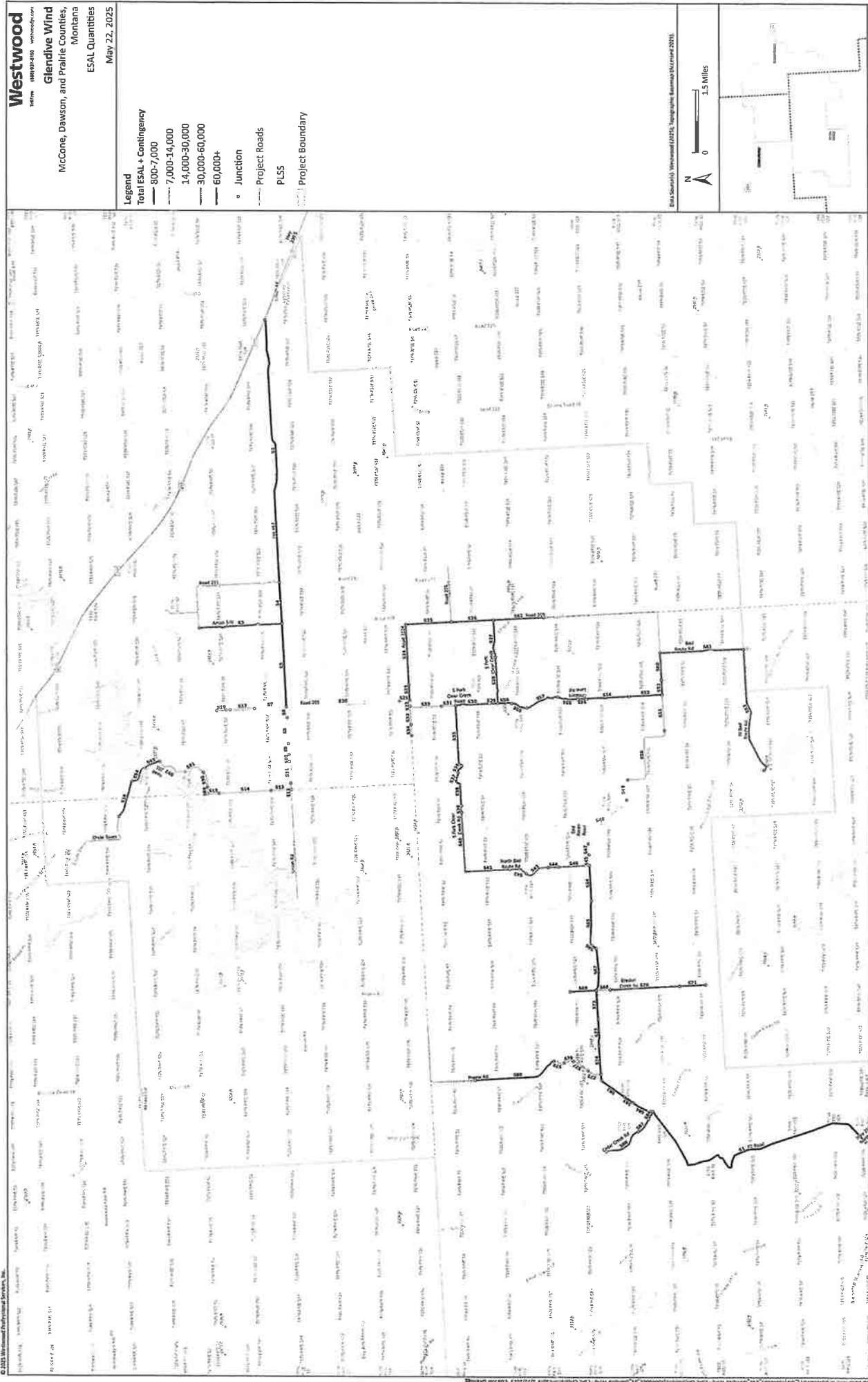

ATTACHMENT F

Delivery Truck Counts
 Project Name: Glendive Wind Project
 Project Number: 46065.01
 Date: 5/13/2025

Road Name	Segment Label	Cumulative Loads on Segment										ESALs						RT Crane ESAL	Total ESAL
		Aggregate Trucks	Turbine Delivery Trucks	Concrete Trucks	Water Trucks	Other Trucks	Crawler Crane Trucks	Empty Trucks	RT Crane	Aggregate ESAL	Turbine ESAL	Concrete ESAL	Water ESAL	Other ESAL	Crawler Crane Truck ESAL	Empty ESAL			
Road 201	S89	1880	160	880	196	160	40	3316	10	4418	833	2341	535	378	94	829	680	10613	
Road 201	S90	1880	160	880	196	160	40	3316	10	4418	833	2341	535	378	94	829	680	10613	
Road 201	S91	1446	120	660	147	120	40	2533	10	3398	625	1756	401	283	94	633	680	8264	
Road 201	S92	1321	110	605	135	110	40	2321	10	3104	573	1609	369	260	94	580	680	7632	
Road 201	S93	1104	90	495	110	90	40	1929	10	2594	468	1317	300	212	94	482	680	6456	
Road 201	S94	886	70	385	86	70	40	1537	10	2082	364	1024	235	165	94	384	680	5280	
Aman 5-N	S3	382	10	55	12	10	40	509	10	898	52	146	33	24	94	127	680	2156	
	S61	923	20	110	25	20	40	1138	10	2169	104	293	68	47	94	285	680	3927	
Bad Route Road	S45	4590	240	1320	294	240	40	6724	10	10787	1249	3511	803	566	94	1681	680	20339	
Bad Route Road	S47	4447	230	1265	282	230	40	6494	10	10450	1197	3365	770	543	94	1624	680	19659	
Bad Route Road	S48	4086	200	1100	245	200	40	5871	10	9602	1041	2926	669	472	94	1468	680	17799	
Bad Route Road	S49	3314	150	825	184	150	40	4663	10	7788	781	2195	502	354	94	1166	680	14237	
Bad Route Road	S50	2593	90	495	110	90	40	3418	10	6094	468	1317	300	212	94	855	680	10521	
Bad Route Road	S51	2321	90	495	110	90	40	3146	10	5454	468	1317	300	212	94	787	680	9778	
Bad Route Road	S52	1077	20	110	25	20	40	1292	10	2531	104	293	68	47	94	323	680	4347	
Bad Route Road	S60	1030	20	110	25	20	40	1245	10	2421	104	293	68	47	94	311	680	4219	
Bad Route Road	S64	17680	570	3135	1791	3885	40	27081	10	41501	2967	8339	4889	9169	94	6770	680	78130	
Bad Route Road	S65	18026	590	3245	1815	3905	40	27621	10	42361	3071	8632	4955	9216	94	6905	680	79709	
Bad Route Road	S66	18695	650	3575	1889	3965	40	28814	10	43933	3383	9510	5157	9357	94	7204	680	83284	
Bad Route Road	S67	19051	670	3685	1913	3985	40	29344	10	44770	3487	9802	5222	9405	94	7336	680	84836	
Bad Route Road	S72	21034	800	4400	2072	4115	40	32461	10	49430	4164	11704	5657	9711	94	8115	680	94033	
Bad Route Road	S73	21341	820	4510	2097	4135	40	32943	10	50151	4268	11997	5725	9759	94	8236	680	95455	
Bad Route Road	S74	21867	860	4730	2146	4175	40	33818	10	51387	4476	12582	5859	9853	94	8455	680	98055	
Bad Route Road	S81	24094	1020	5610	2342	4335	40	37441	20	56621	5309	14923	6394	10231	94	9360	680	108792	
Bad Route Road	S82	24405	1040	5720	2367	4355	40	37927	20	57352	5413	15215	6462	10278	94	9482	1360	110938	
Bad Route Road	S83	24549	1050	5775	2379	4365	40	38158	20	57690	5465	15362	6495	10301	94	9540	680	110908	
Bad Route Road	S84	25734	1060	5775	2379	4565	40	39543	20	60475	5465	15362	6495	10773	94	9886	1360	115405	
Bad Route Road	S85	26176	1090	5995	2428	4605	40	40334	20	61514	5673	15947	6628	10868	94	10084	1360	117776	
Bracket Creek Rd	S68	1553	110	605	135	110	40	2553	10	3650	573	1609	369	260	94	638	680	8265	
Bracket Creek Rd	S69	304	20	110	25	20	40	519	10	714	104	293	68	47	94	130	680	2237	
Bracket Creek Rd	S70	1289	90	495	110	90	40	2114	10	3029	468	1317	300	212	94	529	680	6961	
Bracket Creek Rd	S71	194	10	55	12	10	40	321	10	456	52	146	33	24	94	80	680	1643	
Cedar Creek Rd	S86	653	40	220	49	40	40	1042	20	1535	208	585	134	94	94	261	1360	4484	
Cedar Creek Rd	S87	407	20	110	25	20	40	622	20	956	104	293	68	47	94	156	1360	3232	
Cedar Creek Rd	S88	244	10	55	12	10	40	371	10	573	52	146	33	24	94	93	680	1780	
Circle Tower	S16	669	50	275	61	50	40	1145	10	1572	260	732	167	118	94	286	680	4104	
Fas 467	S2	15372	840	4620	1029	1240	40	23124	10	36124	4372	12289	2809	2926	94	5785	680	68334	
Fas 467	S4	14509	840	4620	1029	1240	40	22278	10	34096	4372	12289	2809	2926	94	5570	680	65978	
Fas 467	S5	13975	830	4565	1017	1230	40	21657	20	32841	4320	12143	2776	2903	94	5414	1360	64944	
Fas 467	S6	4771	270	1485	331	470	40	7367	20	11212	1405	3950	904	1109	94	1842	1360	22970	
Fas 467	S8	4518	250	1375	306	450	40	6939	20	10617	1301	3658	835	1062	94	1735	1360	21685	
Fas 467	S9	3314	250	1375	306	250	40	5535	20	7788	1301	3658	835	590	94	1384	1360	17860	
Fas 467	S10	3170	240	1320	294	240	40	5304	20	7450	1249	3511	803	566	94	1326	1360	17177	

ATTACHMENT F

Road Name	Segment Label	Cumulative Loads on Segment										ESALs						Total ESAL
		Aggregate Trucks	Turbine Delivery Trucks	Concrete Trucks	Water Trucks	Other Trucks	Crawler Crane Trucks	Empty Trucks	RT Crane	Aggregate ESAL	Turbine ESAL	Concrete ESAL	Water ESAL	Other ESAL	Crawler Crane ESAL	Empty ESAL	RT Crane ESAL	
Fas 467	S11	2604	190	1045	233	190	40	4302	20	6119	989	2780	636	448	94	1076	1360	14177
Fas 467	S12	2424	180	990	221	180	40	4035	20	5896	937	2633	603	425	94	1009	1360	13395
Prairie Rd	S75	2190	160	880	196	160	40	3628	10	5147	833	2341	535	378	94	907	680	11459
Prairie Rd	S76	1926	140	770	172	140	40	3188	10	4526	729	2048	470	330	94	797	680	10158
Prairie Rd	S78	1653	120	660	147	120	40	2740	10	3885	625	1756	401	263	94	685	680	8829
Prairie Rd	S79	1513	110	605	135	110	40	2513	10	3556	573	1609	369	212	94	628	680	8156
Prairie Rd	S80	1258	90	495	110	90	40	2083	10	2956	468	1317	300	212	94	521	680	6676
Prairie Road	S77	1787	130	715	159	130	40	2971	10	4223	677	1902	434	307	94	743	680	9512
Road 201	S13	2387	180	990	221	180	40	3998	10	5609	937	2633	603	425	94	1000	680	12580
Road 201	S14	2212	170	935	208	170	40	3735	10	5198	885	2487	568	401	94	934	680	11809
Road 201	S15	1933	160	880	196	160	40	3369	10	4543	833	2341	535	378	94	842	680	10757
Road 205	S20	6321	390	2145	478	390	40	9764	20	14854	2030	5706	1305	920	94	2441	680	29432
Road 205	S21	5837	380	2090	466	380	40	9183	10	13717	1978	5559	1272	897	94	2298	680	27820
Road 205	S7	2578	170	935	208	170	40	4301	20	6058	885	2487	568	401	94	1075	1360	14071
Road 205	S17	2365	160	880	196	160	40	4001	10	5558	833	2341	535	378	94	756	680	9757
Road 205	S18	1673	150	825	184	150	40	3022	10	3932	781	2195	502	354	94	654	680	8543
Road 205	S19	1442	130	715	159	130	40	2616	10	3389	677	1902	434	307	94	554	680	8543
Road 209	S25	607	10	55	12	10	40	734	10	1426	52	146	33	24	94	184	680	2771
Road 209	S26	442	10	55	12	10	40	569	10	1039	52	146	33	24	94	142	680	2320
Road 209	S27	274	10	55	12	10	40	401	10	644	52	146	33	24	94	100	680	1862
Road 224	S22	4824	360	1980	441	360	40	8005	10	11336	1874	5267	1204	850	94	2001	680	24471
Road 224	S23	963	20	110	25	20	40	1178	10	2263	104	293	68	47	94	295	680	4036
Road 224	S24	803	10	55	12	10	40	930	10	1887	52	146	33	24	94	233	680	3306
Road 224	S32	2052	180	990	221	180	40	3663	10	4822	937	2633	603	425	94	916	680	11666
Road 224	S34	1863	170	935	208	170	40	3406	10	4425	885	2487	568	401	94	852	680	10911
S Fork Clear Creek	S27	0	0	0	0	0	40	40	0	0	0	0	0	0	94	10	680	823
S Fork Clear Creek	S28	477	30	165	37	30	40	779	10	1121	156	439	101	71	94	195	680	2999
S Fork Clear Creek Rd	S35	665	40	220	49	40	40	1054	10	1563	208	585	134	94	94	264	680	3803
S Fork Clear Creek Rd	S36	246	20	110	25	20	40	461	20	578	104	293	68	47	94	115	1360	2792
S Fork Clear Creek Rd	S37	0	0	0	0	0	40	40	20	0	0	0	0	0	94	10	1360	1537
S Fork Clear Creek Rd	S38	312	20	110	25	20	40	527	20	733	104	293	68	47	94	132	1360	2973
S Fork Clear Creek Rd	S39	9047	30	165	1129	3345	40	13756	20	21260	156	439	3082	7894	94	3439	1360	39617
S Fork Clear Creek Rd	S40	9783	80	440	1190	3395	40	14928	20	22990	416	1170	3249	8012	94	3732	1360	43075
S Fork Clear Creek Road	S29	1053	70	385	86	70	40	1704	10	2475	364	1024	235	165	94	426	680	5736
S Fork Clear Creek Road	S30	1272	80	440	98	80	40	2010	10	2989	416	1170	268	189	94	503	680	6524
S Fork Clear Creek Road	S31	2542	170	935	208	170	40	4065	10	6472	937	2633	603	425	94	1016	680	12710
S Fork Clear Creek Road	S33	2754	180	990	221	180	40	4365	10	7336	937	2633	603	425	94	1091	680	13582
S Fork Clear Creek Road	S41	9944	80	440	1190	3395	40	15089	10	23368	416	1170	3249	8012	94	3772	680	42800
Unnamed	S42	10872	160	880	1288	3475	40	16715	10	25549	833	2341	3516	8201	94	4179	680	47562
Unnamed	S43	11281	190	1045	1325	3505	40	17386	10	26510	989	2780	3617	8272	94	4347	680	49653
Unnamed	S44	11315	190	1045	1325	3505	40	17420	10	26590	989	2780	3617	8272	94	4355	680	49746
Unnamed	S46	11743	220	1210	1362	3535	40	18110	10	27596	1145	3219	3718	8343	94	4528	680	51788
Unnamed	S53	1110	70	385	86	70	40	1761	10	2609	364	1024	235	165	94	440	680	5892
Unnamed	S54	1000	70	385	86	70	40	1651	10	2350	364	1024	235	165	94	413	680	5591
Unnamed	S55	748	60	330	74	60	40	1312	10	1758	312	878	202	142	94	328	680	4613
Unnamed	S56	611	50	275	61	50	40	1087	10	1436	260	732	167	118	94	272	680	3946
Unnamed	S57	0	0	0	0	0	40	40	10	0	0	0	0	0	94	10	680	823
Unnamed	S58	162	10	55	12	10	40	289	10	381	52	146	33	24	94	72	680	1556

ATTACHMENT F

Road Name	Segment Label	Cumulative Loads on Segment										ESALs						
		Aggregate Trucks	Turbine Delivery Trucks	Concrete Trucks	Water Trucks	Other Trucks	Crawler Crane Trucks	Empty Trucks	RT Crane	Aggregate ESAL	Turbine ESAL	Concrete ESAL	Water ESAL	Other ESAL	Crawler Crane Truck ESAL	Empty ESAL	RT Crane ESAL	Total ESAL
Unnamed	S59	317	20	110	25	20	40	532	10	745	104	293	68	47	94	133	680	2272
W Bad Route Rd	S63	636	20	110	25	20	40	851	10	1495	104	293	68	47	94	213	680	3143
Xit Road	S1	28292	1130	6215	2477	4845	40	42999	20	66486	5882	16532	6762	11434	94	10750	1360	125265

Note: total ESAL column contains a 5% contingency.